

5.ª Conferência Internacional da Rede de Museus da Água  
5th International Conference Of The Global Network Of Water Museums

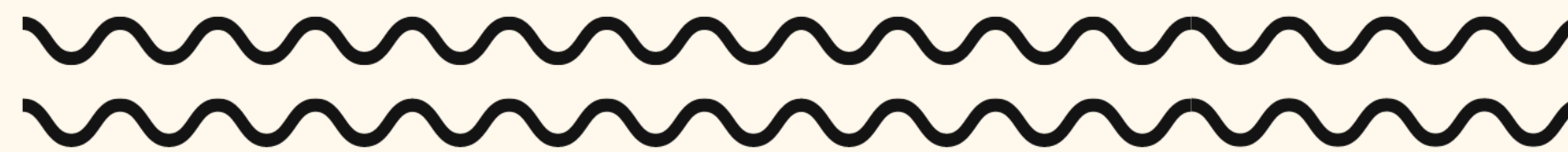

**THE INTERNATIONAL WATER MEMORIAL – MINA**  
*O MEMORIAL INTERNACIONAL DA ÁGUA – MINA*



**ROGERIO ROSSO**

*Coordinating Director of the MINA Project at Adasa, Brasília, Federal District, Brazil*





# THE INTERNATIONAL WATER MEMORIAL – MINA

## *O MEMORIAL INTERNACIONAL DA ÁGUA – MINA*

The **Federal District's Water, Energy and Sanitation Regulatory Agency – (Adasa)** is pleased to present the International Water Memorial Project - MINA.

**MINA** will be an institution dedicated to promoting learning, reflection and exhibitions on the preservation and responsible use of water resources, as well as reproducing the history of water as a vital input for human survival, assuming its essence as a socio-educational, scientific and historical-cultural character for Brazil and the world.

**MINA** will consolidate a pedagogical proposal for disseminating information about water and basic sanitation.

The aim is to raise awareness and mobilize the population to adopt individual and collective practices that promote sustainable development and the conservation of water resources.



## BRASÍLIA, “CRADLE OF WATERS” *BRASÍLIA, O “BERÇO DAS ÁGUAS”*

Located in **Brasilia**, MINA is strategically positioned in the heart of the **Brazilian Cerrado**, a region which, although it has low surface water availability, makes a major contribution to the country's hydrographic basins and is considered the **Cradle of Brazilian Waters**.

The **Federal District** has a unique hydrographic phenomenon called “**Águas Emendadas**”, which consists about the sources of two large river basins flowing from the same point. To the north is the **Araguaia-Tocantins’ basin**, which flows into the **Amazon** region, and to the south is the **Paraná’s basin**. The latter is of international importance as it forms the **Platina basin**, which bathes **Argentina, Paraguay and Uruguay**. In addition, to the east we have the headwaters of the São Francisco River’s Basin, represented by the **Black River’s sub-basin**.



## MINA'S LOCATION LOCALIZAÇÃO DO MINA

**MINA** will be built on the shore of one of the **Federal District's** main postcards - **Lake Paranoá**.

The artificial urban lake, located in central **Brasília**, is a symbol for the people of Brasília and an example of good management of basic sanitation and natural beauty. Conceived in the 19th century and inaugurated along with the new capital, it was created to promote electricity and bring more humidity to the region chosen to be the country's new capital and political headquarters.

Later, it would figure in the projections of the architect and urban planner **Lucio Costa**, eternalized by the urban design of **Brasilia's Pilot Plan**, as a space for preservation and leisure. Today, the lake's multiple uses include landscaping, recreation, energy generation, effluent dilution and human supply.



## A PROJECT BY THE MASTER NIEMEYER *UM PROJETO DO MESTRE NIEMEYER*

MINA's architectural project was originally designed by the master **Oscar Niemeyer**, an exponent of the development of modern architecture and historically linked to the conception and construction of Brasilia. Inaugurated in 1960 by **Juscelino Kubitschek**, the “*Capital of Hope*” emerged from the sketches of **Lúcio Costa**, complemented by Oscar's designs, permeated by the art of **Athos Bulcão**, **Burle Marx** and other great names in architecture, landscaping and modern art.

Today, these sketches of hope are manifested in the sustainable future that **MINA** has as its vision.

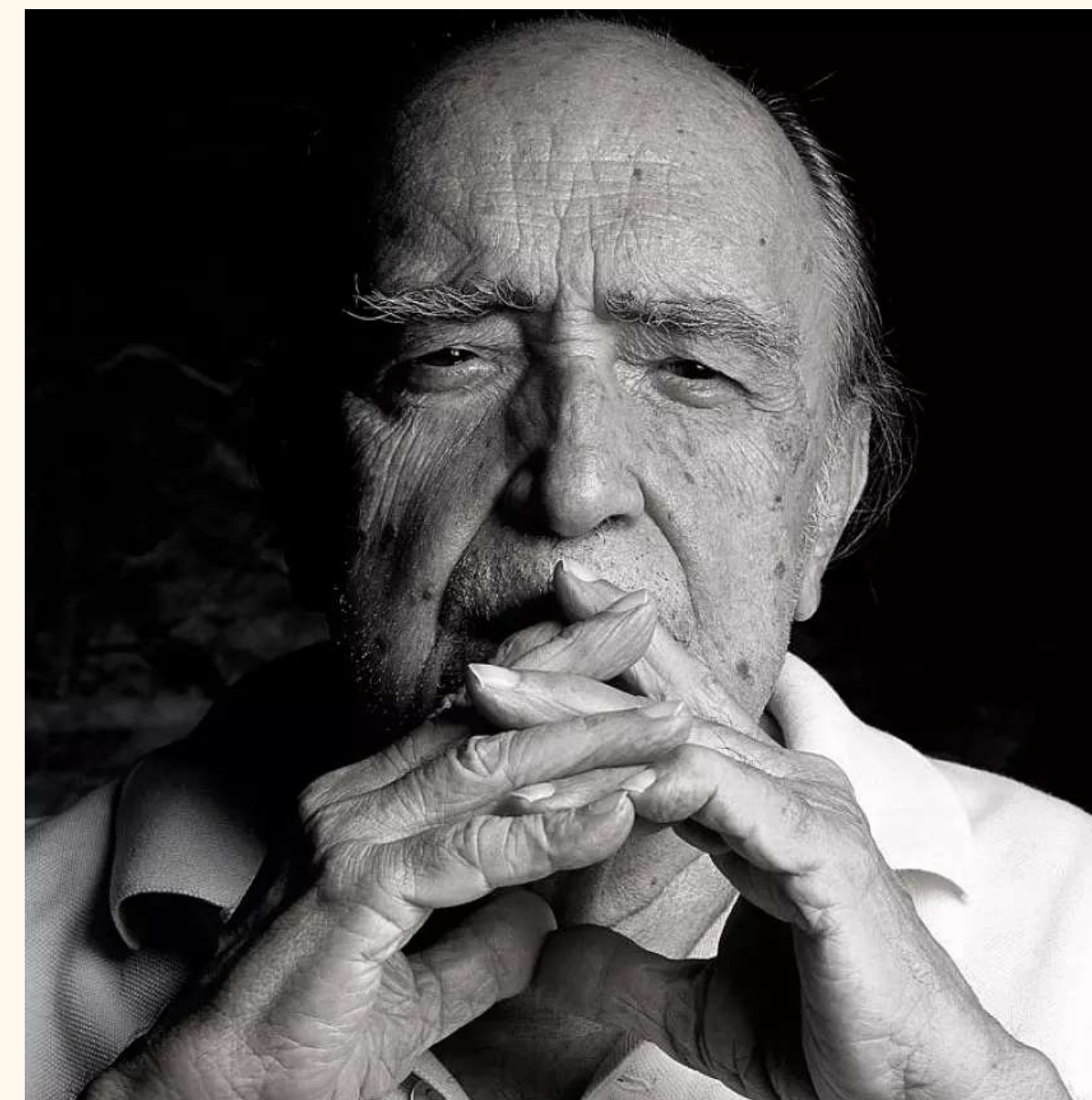

*Oscar Niemeyer*



# A PROJECT FOR THE WORLD

## UM PROJETO PARA O MUNDO

**MINA** will be at the forefront of global discussions on water resources, promoting management, education, research and the memory of sanitation policies in cooperation with service providers, companies and local, national and international organizations.

The **MINA complex** will include the **International Water Museum**, the **Water Studies Center**, the **Theater** and an **administrative structure**.

The **World Water Council**, in which Brazil participates with two members of **Adasa's Board of Directors**, has already approved its participation in the Commission to monitor the implementation of **MINA** until its inauguration.

And, from this moment on, MINA is, with great satisfaction, another member of this **Global Network of Water Museums**.

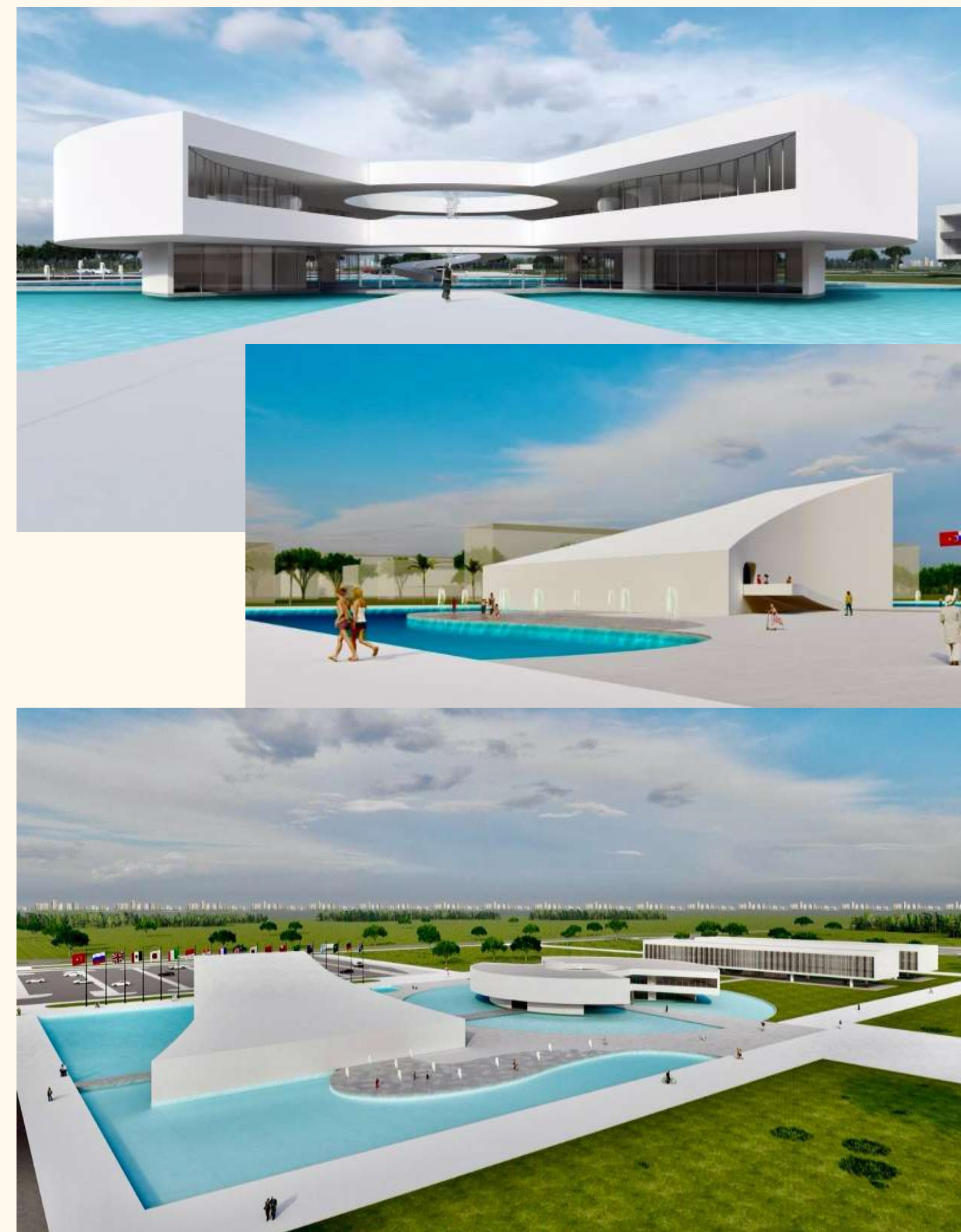

wamu-  
net

# THE PROJECT *(O PROJETO)*



MINA



wamu-  
net

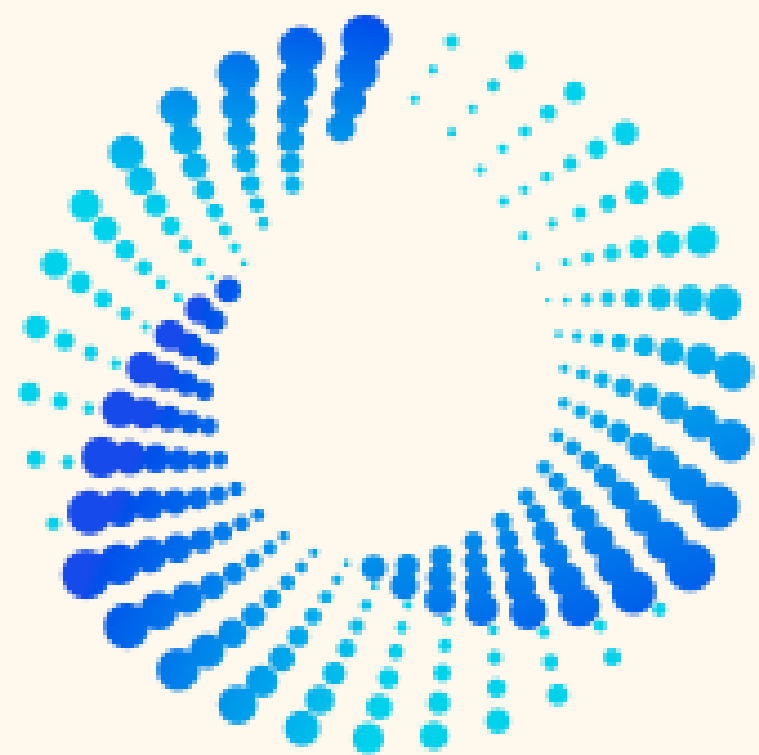

MINA

MEMORIAL  
INTERNACIONAL  
DA ÁGUA

**Building a cycle of consciousness**

*Um novo ciclo de consciência*

**mina.eco.br**



Coordenação



Em parceria



Porto.



*On behalf of the entire  
Board of Directors of ADASA  
and the MINA Project team, our ...*

obrigado  
thank  
you



MINA



Porto.